

# NS-23

## Fresnel Lens with Metal Trim

### TRIM DIMENSIONS

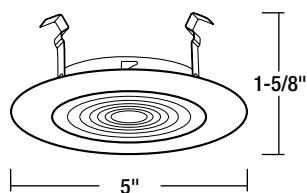

Trim OD: 5"  
Height: 1-5/8"

### FEATURES

#### Trim

High grade fresnel lens attached to metal trim.

#### Mounting

Trim includes three trim clips that securely mount trim in housing.

#### Compatible Housings

Compatible with Line Voltage and Compact Fluorescent housings.  
See individual specification sheets for more information.

#### Lamp

##### Line Voltage

50W R20/PAR20 Max. (NS-401QAT; NSIC-401QAT; NSR-404QAT)

##### Compact Fluorescent

13W Quad/Triple (NS-406Q; NS-406EL; NSR-408Q; NSR-408EL)

#### Labels and Listings

cULus Listed for Wet Location when used with compatible housing.

### Fresnel Lens with Metal Trim

- ☐ NS-23B: Fresnel Lens with Black Metal Trim
- ☐ NS-23BZ: Fresnel Lens with Bronze Metal Trim
- ☐ NS-23C: Fresnel Lens with Chrome Metal Trim
- ☐ NS-23CO: Fresnel Lens with Copper Metal Trim
- ☐ NS-23G: Fresnel Lens with Gold Metal Trim
- ☐ NS-23N: Fresnel Lens with Natural Metal Trim
- ☐ NS-23W: Fresnel Lens with White Metal Trim

**NORALIGHTING.**

Type

Project

Catalog No.

Lamp/Wattage

### HOUSING DIMENSIONS

#### NS-401QAT

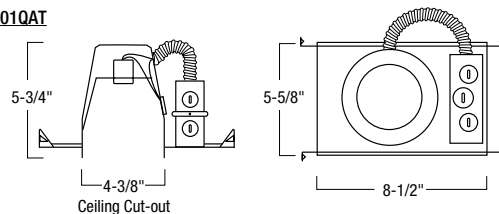

#### NSIC-401QAT

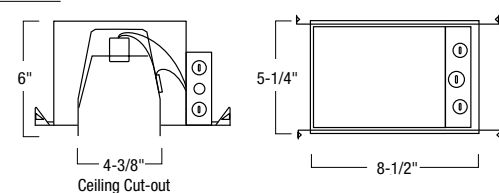

#### NSR-404QAT

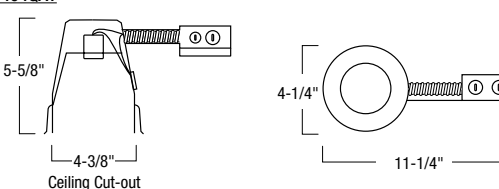

#### NS-406Q / NS-406EL

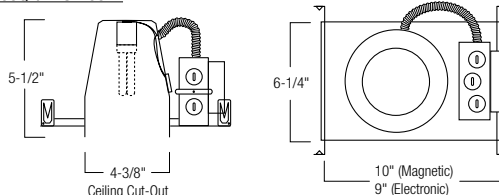

#### NSR-408Q / NSR-408EL

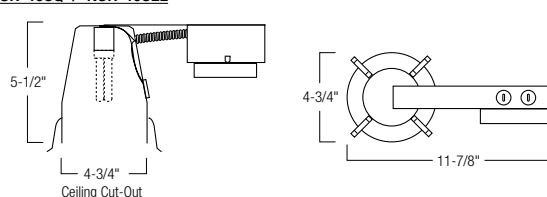

### Compatible Housings

#### LINE VOLTAGE

Item Number	Installation Type	Lamp	Dimensions
<input type="checkbox"/> NS-401QAT	Non-IC Air-Tight New Const.	50W R/PAR20	W: 5-5/8" L: 8-1/2" H: 5-5/8"
<input type="checkbox"/> NSIC-401QAT	IC Air-Tight New Construction	50W R/PAR20	W: 5-1/4" L: 8-1/2" H: 6-3/8"
<input type="checkbox"/> NSR-404QAT	Non-IC Air-Tight Remodel	50W R/PAR20	W: 4-1/4" L: 11-1/4" H: 5-5/8"

#### COMPACT FLUORESCENT

<input type="checkbox"/> NS-406Q	Non-IC New Constr., Magnetic	13W Quad	W: 6-1/4" L: 10" H: 5-1/2"
<input type="checkbox"/> NS-406EL	Non-IC New Constr., Electronic	13W Quad/Triple	W: 6-1/4" L: 9" H: 5-1/2"
<input type="checkbox"/> NSR-408Q	Non-IC Remodel, Magnetic	13W Quad	W: 4-3/4" L: 11-7/8" H: 5-1/2"
<input type="checkbox"/> NSR-408EL	Non-IC Remodel, Electronic	13W Quad/Triple	W: 4-3/4" L: 11-7/8" H: 5-1/2"

**NORALIGHTING.**

6505 Gayhart St., Commerce, CA 90040  
www.noralighting.com • Specifications subject to change without notice. © 2011  
Phone: 800.686.6672 • FAX: 800.500.9955 • e-mail: nora@noralighting.com